

COPOLYMER POLYPROPYLENE
PLASTIC 1/2" GRADE 60
STEEL REINFORCEMENT

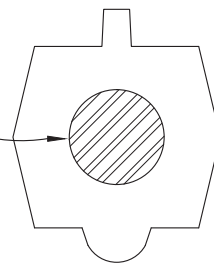
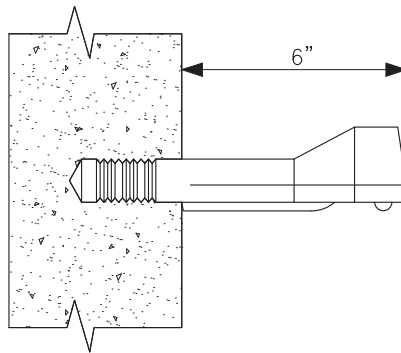

SECTION A-A

NOTE:
MANHOLE STEPS SHALL BE COPOLYMER
POLYPROPYLENE PLASTIC COATED 1/2"
GRADE 60 STEEL REINFORCEMENT, MODEL
PS2-PF, AS MANUFACTURED BY M.A.
INDUSTRIES INC., OR APPROVED EQUAL

MANHOLE SAFETY STEP

NOT TO SCALE

NOTES:

- ONLY THE LATEST DETAIL, AS APPROVED BY THE DIRECTOR OF PUBLIC WORKS, SHALL BE USED.

ORIG.	10/06		
Revision	Date	Description	Appr

CITY OF SELAH-STANDARD DETAIL

MANHOLE SAFETY STEP

SS-6